

OCPP Network Configuration via Bluetooth

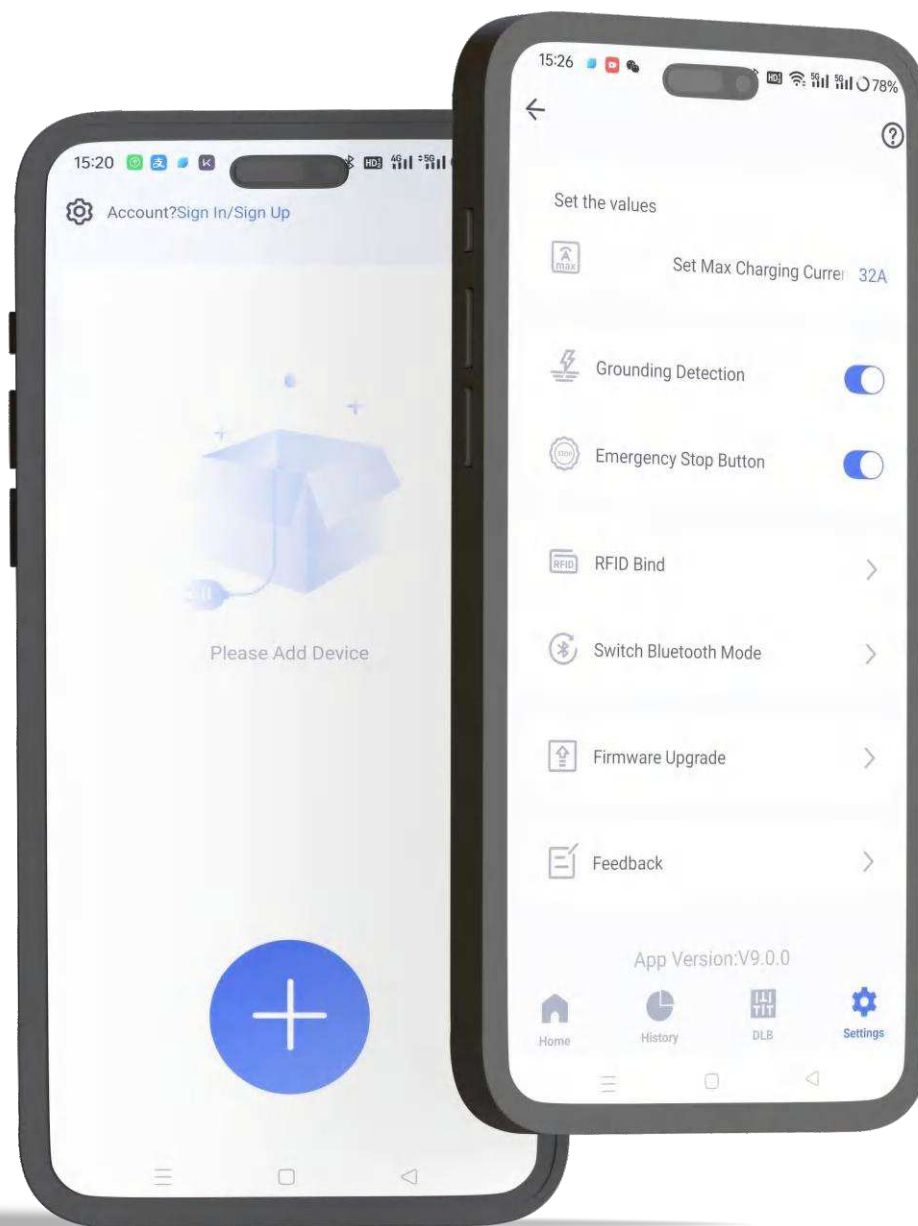

CONTENTS

1. Download Z-BOX	01
2. You need to know	01
3. Register and log in the account	01
3.1. Register	01
3.2. Login	02
4. Connect the charger with your mobile phone by Bluetooth	02
5. Cloud Server Selection	03
6. Connect to cloud server	04
6.1. Select the Network	05
6.2. Wait for complete	07
7. Appendix 1. Connect to other servers	07
7.1. Select the server	07
7.2. HTTP Setting	09
7.3. Server parameter configuration	09
8. Appendix 2. How to reset the charger to Bluetooth mode	10

1. Download Z-BOX



2. You need to know

1. Ensure the AC charger is power ON and the connector is not plug with EV.
2. Ensure the AC charger is in Bluetooth mode. And your mobile phone Bluetooth is ON. (Bluetooth mode is as default, refer to Appendix 2 for the reset).

3. Register and log in the account

3.1. Register

Use your email address to register your account.

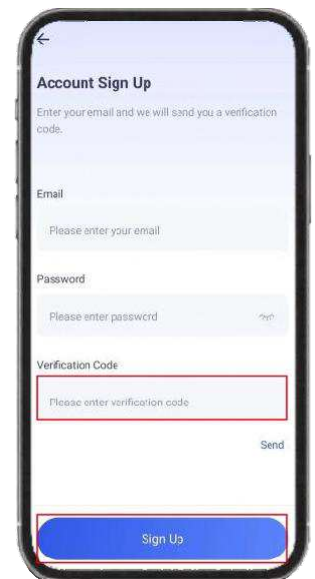

3.2. Login

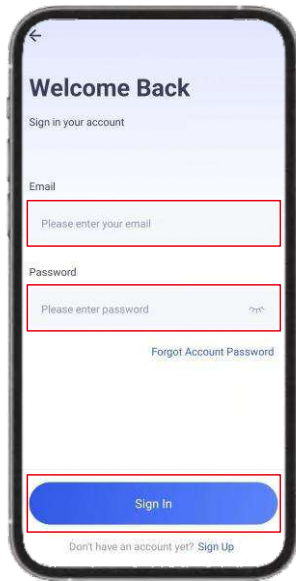

4. Connect the charger with your mobile phone by Bluetooth

·Click the "+" on the home page.

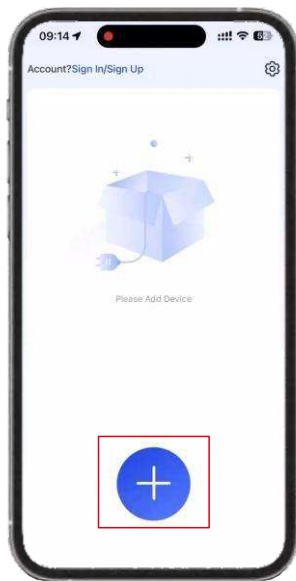

·Click the corresponding charger ID.

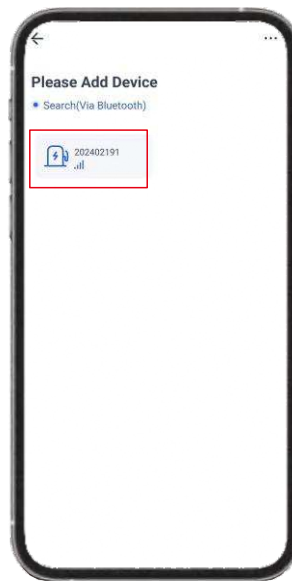

·Enter the password (Default password is "123456") and click the "Connect" button.

·Click the "Cancel" button, and the AC charger is added successfully.

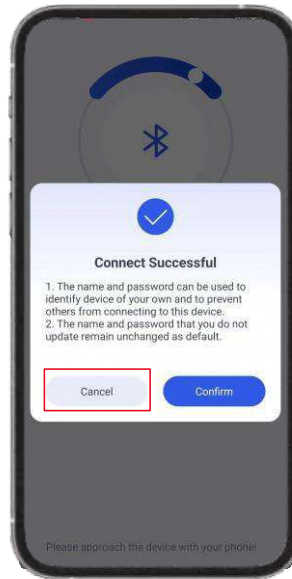

Note:
The App will keep the default name and password if you didn't revise the Name and password. You can reset the name and password of the charger for a higher level safety.

5. Cloud Server Selection

After charger is added in the APP via Bluetooth, you can also upload the charger to OCPP cloud if you prefer cloud roaming or your serve supplier.

·Click the Settings button.

·Click the "Switch Remote Control Mode" button to enter the server configuration interface.

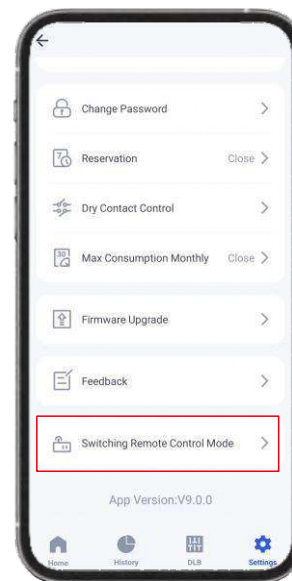

6. Connect to cloud server

This step only explain the cloud serve configuration of Z-BOX. (Other cloud serves, please refer to Appendix 1.)

·Click and select "Z-BOX".

·Click the "Next" button button to enter the parameter setting interface.

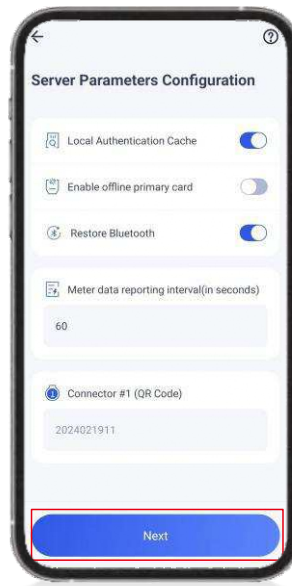
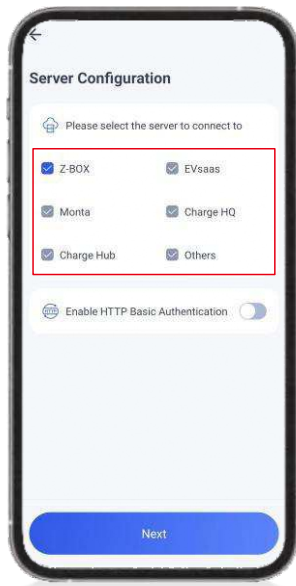

·The parameter setting interface is not mandatory, you can keep the default and click "Next" to enter the next configuration.

6.1. Select the Network

Wi-Fi

- Select the "Wi-Fi" option.
- Enter the information:
Wi-Fi SSID and Wi-Fi password.
- For Dynamic IP (DHCP) network,
please click "Next".
- If you need to set a fixed IP address, click
enable static IP and fill in the corresponding
IP address, subnet mask and default gateway.
Click "Next".

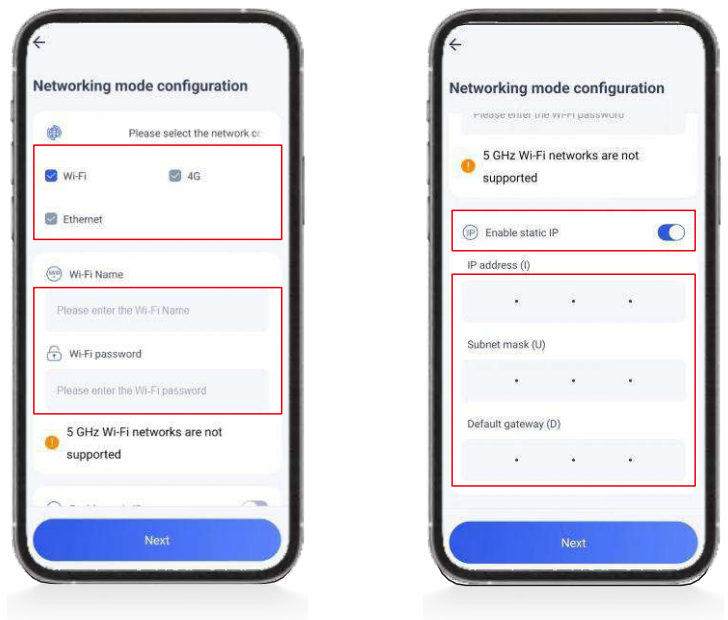

Configuration Item	Explanation of Configuration Items	Maximum Length
Wi-Fi SSID	This configuration requires entering the name of the Wi-Fi. The Wi-Fi will be connected to the EV charger when "Wi-Fi Custom" is selected in the networking mode.	30
Wi-Fi password	This configuration requires entering the Wi-Fi password when Wi-Fi Custom is selected in the networking mode.	30

4G

·Ensure the charger supports 4G function and confirm that the SIM card which is not encrypted by PIN code has been inserted.

·Select "4G" option, and fill in the corresponding network information: APN, APN user and APN password.

·For Dynamic IP (DHCP) network, please click "Next".

If you need to set a fixed IP address, click enable static IP and fill in the corresponding IP address, subnet mask and default gateway. Click "Next".

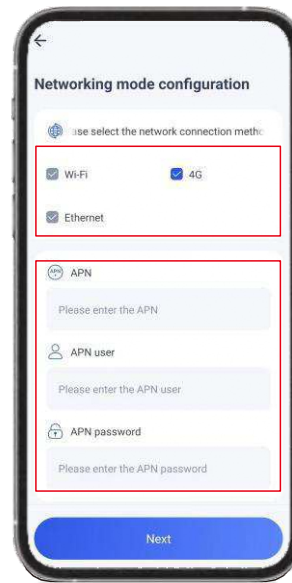

Configuration Item	Explanation of Configuration Items	Maximum Length
APN	You need to enter the name of the 4G network access point of the SIM card when selecting 4G connectivity mode.	
APN user	APN username, not required if it is unavailable.	30
APN password	APN user password, not required if it is unavailable.	30

Ethernet

·Ensure you connect the network cable to the Ethernet RJ 45 port of the EV charger.

·Select the "Ethernet"option.

·For Dynamic IP (DHCP) network, please click "Next".

·If you need to set a fixed IP address, click enable static IP and fill in the corresponding IP address, subnet mask and default gateway. Click "Next".

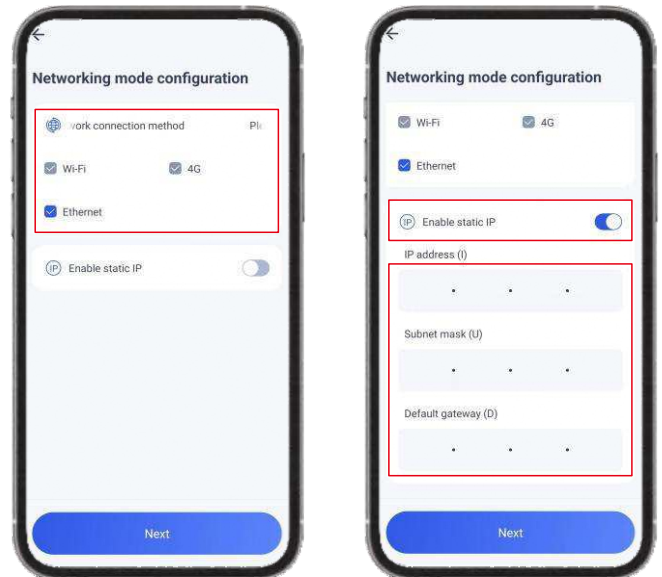

6.2. Wait for complete

- After click the "Next" button, and the charger will turn off the Bluetooth and try to connect to the OCPP server.
- Please wait one to two minutes until the charger to connect the server.
- Check the configuration parameters if anything goes wrong.
- For other serves, please go to your supplier's APP and check the situation.

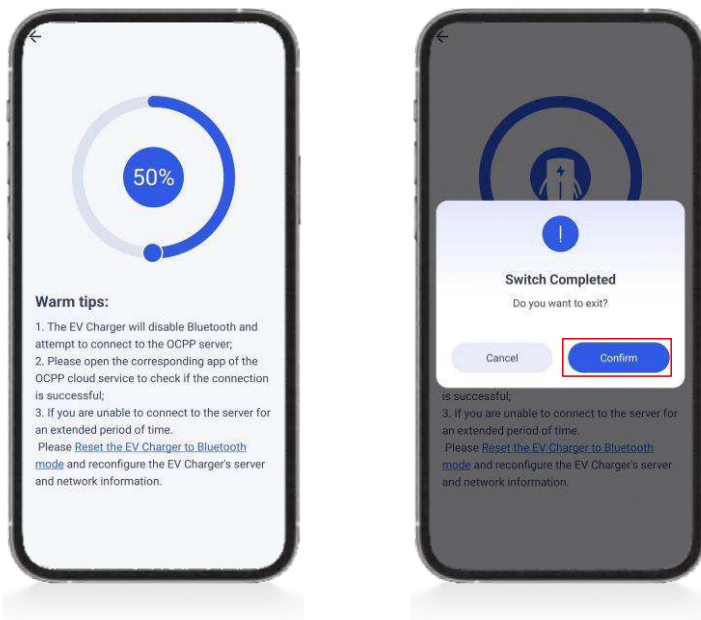

7. Appendix 1. Connect to other servers

7.1. Select the server

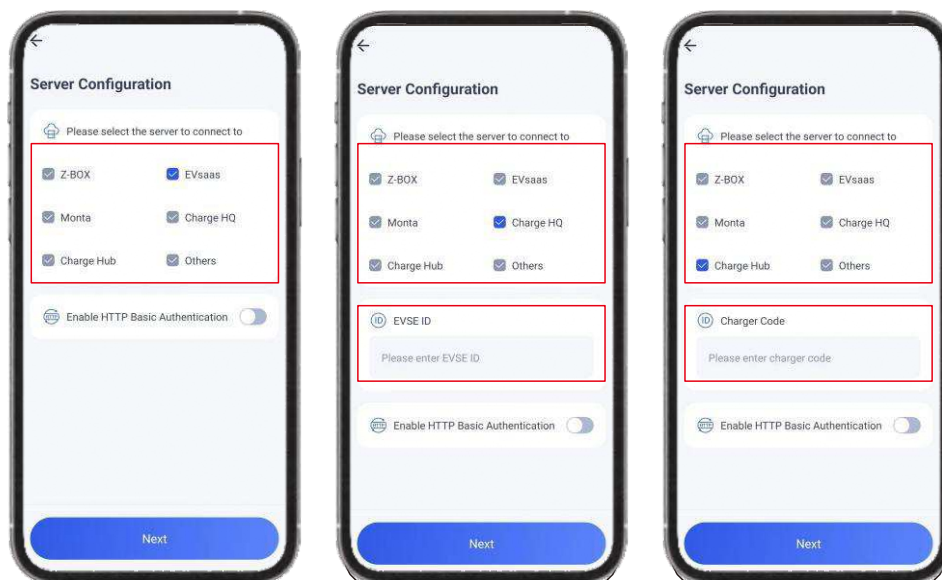

- Click to select the server.
- EVsaas: you can proceed directly to the next configuration.
- Servers in the list require the user to enter the EV charger ID.

* "others": the server URL address is manually entered for the next configuration.

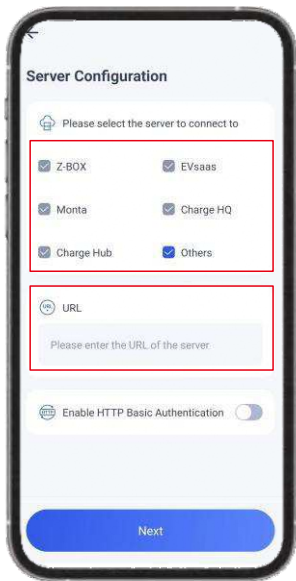

The URL can be any unified resource locator with "ws" or "wss" as the transport protocol, The syntax format is ws: // <central system hostname>: <central system port> / <charge point path> / <charge point identifier> or wss: // <central system hostname>: <central system port> / <charge point path> / <charge point identifier>.

Description of URL:

Configuration Item	Explanation of Configuration Items	Maximum Length
Central System Hostname	Server domain name or IP address	50
Central System Port	If the URL does not specify a special port, the default port is 443 when SSL is enabled. Otherwise the default port is 80.	
Charge Point Identity	Charge point number	30
Charge Point Path	For example, in the URL, the URL is: ws://<central system hostname>:<port>/ocpp/16J/<charge point identifier> The charge point path is ocpp/16J.	50

7.2. HTTP Setting

- If you choose to enable HTTP, you should fill in the corresponding HTTP authentication user and HTTP authentication key.

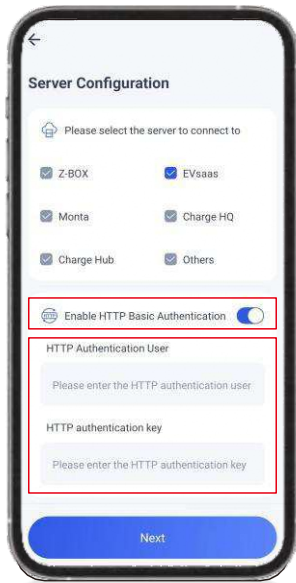

Configuration Item	Explanation of Configuration Items	Maximum Length
HTTP Basic Authentication Enable / Unable	Whether this option is turned on or not depends on whether the OCPP Cloud Platform service requires it. If it is required, you need to enter a different check name and password for each EV charger. If you enter it incorrectly, the EV charger will fail to connect to the server.	
HTTP Authentication User	HTTP authentication username generally matches the charging station identity.	50
HTTP Authentication key	HTTP Authentication password	20

7.3. Server parameter configuration

- Click the "Next" button to enter the server parameter configuration interface.
- Enable or Unable the configurations.

Configuration Item	Explanation of Configuration Items	Configuration Range
Local Authentication Cache	Enable:When the charger is offline, the recorded IC card still start or stop the charger.	
Enable offline primary card	The primary card will be allowed to start charging even temporarily offline.	
Bluetooth-Reset	Quick reset Bluetooth mode: When the charger is powered on through the emergency stop button and small test button.	
Meter data report interval	The interval of the charger to report the data (unit: seconds). Default value is recommended.	30~300
# 1 (QR code)	This configuration will affect the content of the QR code on the LCD screen.	
# 2 (QR code)		

Note:The Bluetooth-reset refers to the button quick reset Bluetooth mode. The quick reset Bluetooth mode is only valid within 10 minutes on the charger, once this function is closed, you have to active it through WEB configuration.

- When the server parameter configuration is complete, please return to the Chapter 6 of this manual to continue the networking configuration and connect to other servers.

8. Appendix 2. How to reset the charger to Bluetooth mode

Method 1 (recommended when the quick Bluetooth reset function is not enabled)

Referring to the OCPP charger into the offline mode manual, configure network as Offline (Plug and Play) or Offline (RFID), and the charger enters Bluetooth mode.

Method 2 (it is recommended to use the quick Bluetooth reset function)

The quick reset Bluetooth function is unable by default. You need to make WEB configuration and enable "BEL Beset Button".



- Ensure the AC charger is power ON and the connector is not plug with EV.
- Press the emergency stop button, and then long press the test button for more than 10 seconds.
- After you hear beeps sound, release the function test buttons.

